

PLANT                      GROWTH RATE

- WHITE PINE • 2'+ PER YEAR
- AMERICAN HOLLY • 12"-20" PER YEAR
- WINTERBERRY • 12"-20" PER YEAR
- HIGHBUSH BLUEBERRY • LESS THAN 12" PER YEAR
- NORTHERN ARROWWOOD/VIBURNUM • 12" TO 24" PER YEAR
- BAYBERRY • 12"-24" PER YEAR
- CLETHRA • LESS THAN 12" PER YEAR
- LARCH • 12"-18" PER YEAR

FOR EACH CIRCLE BELOW I CHOSE THE MID-RANGE GROWTH RATE.

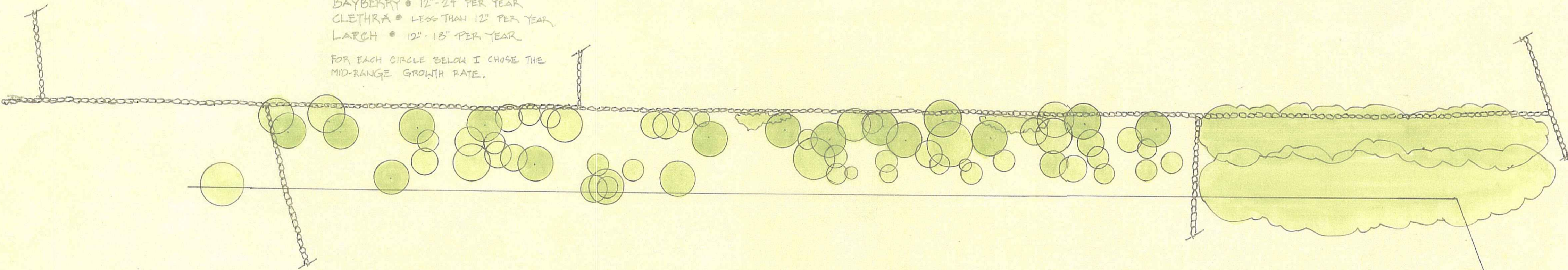

OVERLAY SHOWS PROJECTED 10 YEAR GROWTH OF THE OBSERVED EXISTING UNDERSTORY PLANT SPECIES, BASED UPON AVERAGE ANNUAL GROWTH RATE OF EACH INDIVIDUAL SPECIES. ACTUAL GROWTH IS DEPENDENT ON A VARIETY OF FACTORS. NOTE - THIS ILLUSTRATION INCLUDES ONLY SOME UNDERSTORY PLANTINGS, AND DOES NOT INCLUDE THE CANOPY GROWTH/LARGE TREES.

NORTHERN PERIMETER BUFFER  
 APPROXIMATE UNDERSTORY PLANT GROWTH  
 OVER TEN YEARS TIME